



FLUSH GENIE®

SIDE MOUNT SENSOR/TIMER URINAL FLUSHOMETER

Model
HSM-801FG-CU-10

Description

Battery Powered, Sensor/Programmable Timer Operated FLUSH GENIE® Side Mount Exposed Urinal Flushometer for Wall Hung Top Spud Bowls.

Flush Cycle

□ Model HSM-801FG-CU-10 (1.0 gpf/ 3.8 Lpf)

Features

- Patented Gear Motor Drive
- Built-in Sensor Mode and Timer Mode for Ultimate Functionality
- Programmable Settings on Timer Mode Allow Flushing Once Every 30 Minutes, 1, 2, or 3 Hours
- Electronic Push Button- Front (Sensor Mode Only)
- Mechanical Override- Side (Using Manual Flush Key)
- Vandal and Water Resistant Design
- Chrome Plated Metal Housing
- Quiet Operation
- Operates on (4) "C" Alkaline Batteries (Included)
- Battery Life - 3+ Years
- "Low Battery" Blinking LED Indicator
- Easy Battery Replacement-No Water Shut Off Necessary
- Adjustable Sensor Distance (Sensor Mode Only)
- Optional Three (3) Second Flush Delay (Sensor Mode Only)
- Optional 24-Hour Flush (Sensor Mode Only)
- Uses Proprietary Silicone Diaphragm with Filtered Bypass
- 3/4" I.P.S. Angle Stop
- Adjustable Tailpiece
- High Back Pressure Vacuum Breaker with Single Piece Hex Coupling Nut
- Spud Coupling and Flange for 3/4" Top Spud
- Sweat Solder Kit and Wall Flange with Set Screw
- Low Consumption For Water Conservation



*HSM-801FG-CU units include a Valve Body, Supply Stop and Vacuum Breaker.

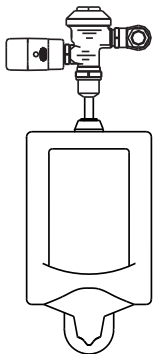

The FLUSH GENIE® Advantage

The FLUSH GENIE® is a fully programmable automatic flush device for urinals and toilets. The smart design allows the device to be switched between sensor activated mode and timer controlled mode. When in SENSOR activated mode, the unit sends out an infrared beam that senses a user on a urinal or toilet. Once the user walks away from the fixture the unit triggers the fixture to flush automatically. The unit includes an electronic push button to allow for a courtesy flush option.

When in TIMER controlled mode, the unit converts most urinals into water efficient fixtures by controlling the amount of daily flushes. The flush intervals can be programmed to flush once every 30 minutes, 1, 2, or 3 hours. The unit will go to SLEEP if a user is NOT detected within 135 minutes since the last use to prevent flush activation while the facility is closed. A mechanical manual flush override using the provided MANUAL FLUSH KEY will allow the custodial staff (not the user) to flush the unit manually at any time.

(Note: electronic push button is deactivated in TIMER mode).

Warranty
5 Years

AXIO®
TOUCH-FREE TECHNOLOGY

ADA Compliant

Architect/Engineer Approval

| | |
|----------------------|-------|
| Job Name | _____ |
| Date | _____ |
| Model Specified | _____ |
| Quantity | _____ |
| Variations Specified | _____ |
| Customer/Wholesaler | _____ |
| Contractor | _____ |
| Architect | _____ |

For Finish Variations Please Consult Factory

The information contained in this document is subject to change without notice.
Revision (09/17)



FLUSH GENIE®

SIDE MOUNT SENSOR/TIMER URINAL FLUSHOMETER

Model
HSM-801FG-CU-10

Specifications:

| | |
|----------------------------------|---|
| Operation: | Sensor Operated or Programmable Timer |
| Outer Casing: | Standard-Chrome Metal |
| Operating Water Pressure: | 15 PSI - 100 PSI |
| Sensor Type: | Infrared |
| Battery Type: | Four "C" Alkaline Batteries |
| Battery Life: | 3+ Years |
| Arming Delay: | 5 Seconds (Sensor Mode Only) |
| Sensing Range: | Adjustable, Default Set to 24" (610mm) |
| Sensor Mode: | Can be Turned On and Off |
| Flush Delay | 3 Seconds Delay Before Activating Flush |
| 24 Hour Flush | Once Every 24 Hours After Last User |
| Timer Mode: | Flushes once every 30 min., 1, 2, or 3 Hours |
| Flush Cycle: | 1.0 gpf/3.8 Lpf |
| Manual Override: | Electronic Button/Mechanical Override |

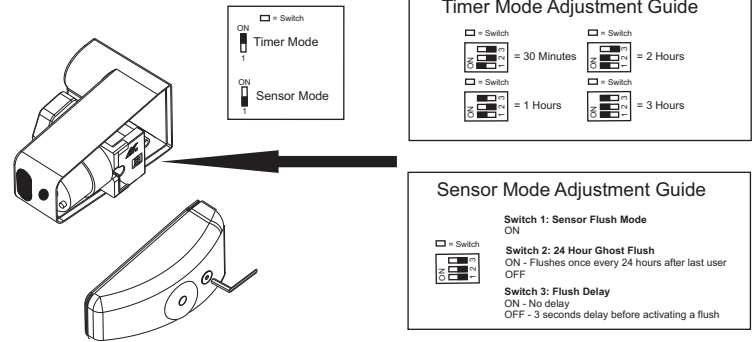

Visual Indicator Guide

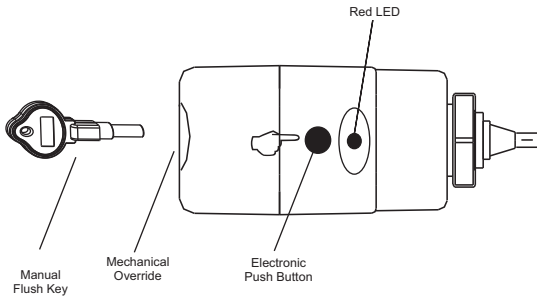

Red LED - Constant blinking red LED indicates batteries are low and need replacing.

Electronic Push Button - Allows manual activation of flush when needed in sensor mode only.

Mechanical Override - Allows manual activation of flush by custodial staff when needed using manual flush key.

Operation and Dimensions when installed on a Urinal Flushometer:

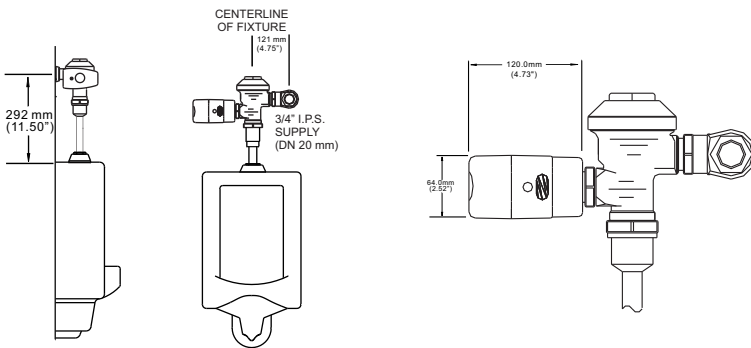

Sensor Mode:

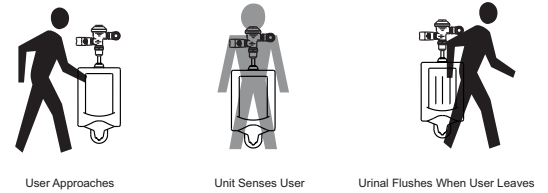

Timer Mode:

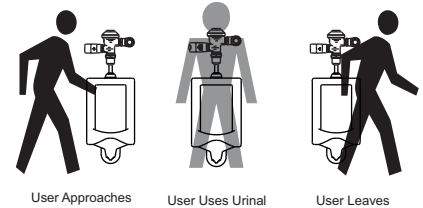

FLUSH GENIE® Side Mount Components:

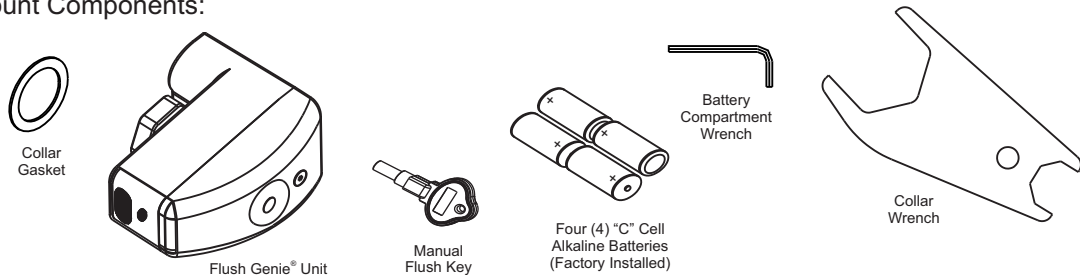

Advanced Modern Technologies Corporation • 19800 Nordhoff Place • Chatsworth, CA 91311
Tel: (818) 883-2682 • Toll Free: (800) 874-7822 • Fax: (818) 883-2620 • www.amtcorporation.com