



HYBRIDFLUSH® TOP MOUNT

AUTOMATIC CONCEALED WATER CLOSET FLUSHOMETER

Model
AEF-801DF-WBCCT-16

Description

Hardwired, Sensor Operated HYBRIDFLUSH® Top Mount
Wall Box Concealed Dual-Flush Water Closet (Toilet)
Flushometer for Floor Mounted or Wall Hung Top or Rear Spud Bowls.

Flush Cycle

☐ Model AEF-801DF-WBCCT-16 (1.6 gpf/6.0 Lpf and 1.1 gpf/4.2 Lpf)

Features

- User present for less than 60 seconds initiates a reduced flush (1.1 gpf/4.2 Lpf) eliminating liquid and paper waste
- User present for more than 60 seconds initiates a full flush (1.6 gpf/6.0 Lpf) eliminating solid and paper waste
- Reduced flush consumes up to 30% less water
- Patented BRV® and Gear Motor Drive
- Wall Box Plate with Sensor
- Hands Free Infrared Sensor Activation
- Vandal and Water Resistant Design
- Chrome Plated All Metal Housing
- Quiet Operation
- Electronic Flush Button
- Operates on 6-Volt DC Power (Transformer Sold Separately)
- Adjustable Sensor Distance
- Optional Three (3) Second Flush Delay Mode
- Optional 24-Hour Flush Mode
- Uses Proprietary Silicone Diaphragm with Filtered Bypass
- 1" I.P.S. Angle Stop
- Adjustable Tailpiece
- High Back Pressure Vacuum Breaker with Single Piece Hex Coupling Nut
- Spud Coupling and Flange for 1 1/2" Top or Rear Spud
- Sweat Solder Kit and Wall Flange with Set Screw
- High Efficiency For Water Conservation

*AEF-801DF-WBCCT units include a
Valve Body, Supply Stop
and Vacuum Breaker.

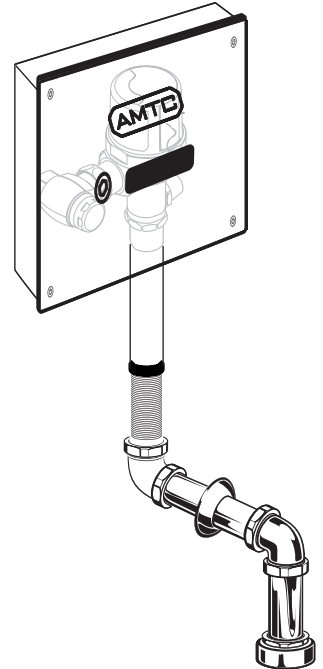
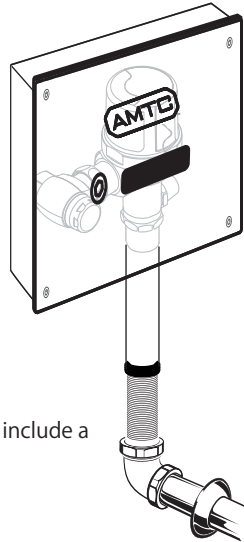

The HYBRIDFLUSH® Advantage

The **HYBRIDFLUSH®** is a revolutionary full-featured automatic flushometer. The **HYBRIDFLUSH®** incorporates a unique patented mechanism that allows for unsurpassed reliability. The **HYBRIDFLUSH®** by Advanced Modern Technologies Corporation is the most efficient, economical, and complete automatic flush valve system on the market.

Code Compliance (Listed By ICC-ES)



- ASSE 1037-2015
- ASME A112.1035-2015
- CSA B125.37-15

Warranty
5 Years

AXIO®
TOUCH-FREE TECHNOLOGY

ADA Compliant

Accessories (Add suffix to model number for accessories)

☐ AMTCTRANS6VDC - 6-Volt AC/DC Transformer

For Finish Variations Please Consult Factory

Architect/Engineer Approval

| | |
|----------------------|-------|
| Job Name | _____ |
| Date | _____ |
| Model Specified | _____ |
| Quantity | _____ |
| Variations Specified | _____ |
| Customer/Wholesaler | _____ |
| Contractor | _____ |
| Architect | _____ |

The information contained in this document is subject to change without notice.
Revision (04/25)



HYBRIDFLUSH® TOP MOUNT

AUTOMATIC CONCEALED WATER CLOSET FLUSHOMETER

Model
AEF-801DF-WBCCT-16

Specifications:

| | |
|----------------------------------|--|
| Operation: | Automatic |
| Outer Casing: | Standard-Chrome Metal |
| Operating Water Pressure: | 15 PSI - 100 PSI |
| Sensor Type: | Infrared |
| Power Type: | 6-Volt DC Power |
| Arming Delay: | 5 Seconds |
| Flush Delay: | 3 Seconds |
| Sensing Range: | 18" (45cm) - 30" (75cm) Adjustable |
| Ghost Flush: | Once Every 24 Hours From Last Flush |
| Sensor Angle: | Fixed Angle |
| Flush Cycle: | Specified by Model |
| Model AEF-801DF-WBCCT-16 | 1.6 gpf/6.0 Lpf and 1.1 gpf/4.2 Lpf |
| Flush Mode: | After Every Use |
| Manual Override: | Electronic Flush Button |

Application:

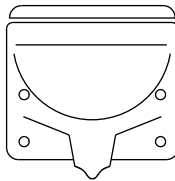
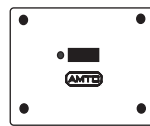
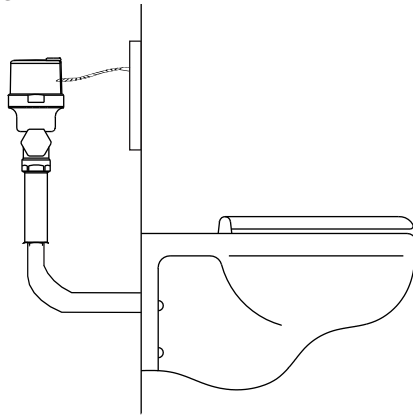

360 mm
(14.18")

Dimensions:

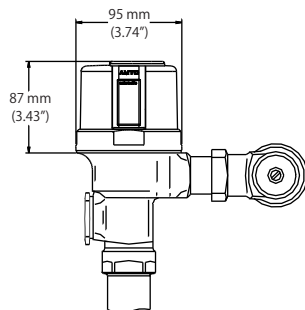

320 mm
(12.63")

Exploded View:

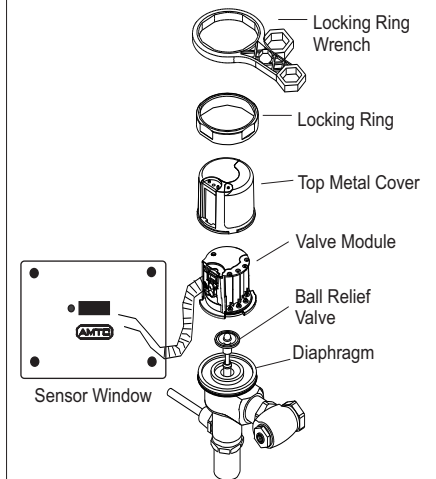

Advanced Modern Technologies Corporation • 8367 Canoga Avenue • Canoga Park, CA 91304
Tel: (818) 883-2682 • Toll Free: (800) 874-7822 • Fax: (818) 883-2620 • www.amtccorporation.com